

LOC		DIST		REVISIONS			
TR	BY	DATE	DESCRIPTION	DATE	OWN	APVD	
C			REVISED PER EC 0513-0122-02	22APR02	DD	CC	

- ① MATERIAL: HOUSING - NYLON, UL94V-0 (COLOR - BLACK).
CONTACTS - 0.25 THK COPPER ALLOY.
- ② CONTACT FINISH: 0.003 MIN THK TIN-LEAD OVER 0.00127 MIN THK NICKEL, ALL OVER.
- ③ CONTACT OMITTED FROM POSITION SHOWN.
- 4. SOLDER TAIL MEETS AMP SOLDERABILITY SPECIFICATION 109-11-2.
- 5. MATES WITH SIMILARLY PLATED AMP-DUAC™ POWER CONNECTOR RECEPTACLE HOUSINGS/SOCKET CONTACTS.

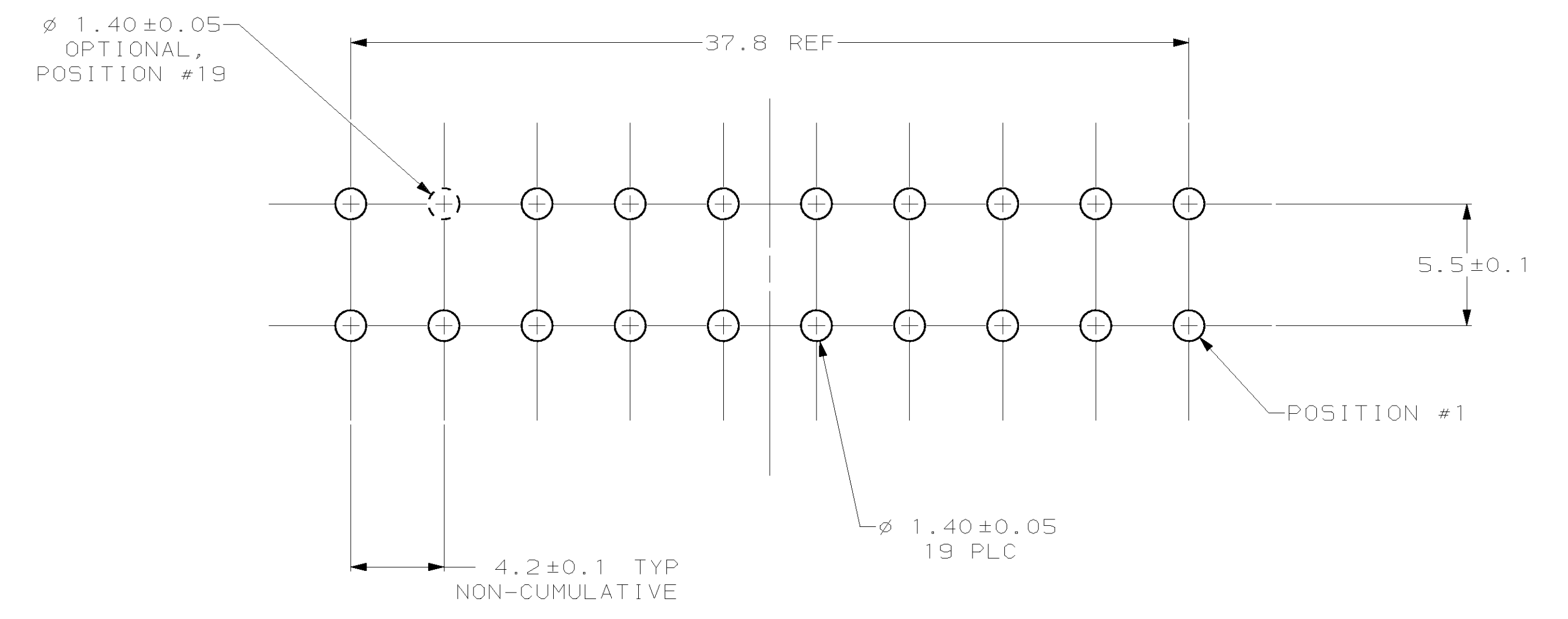

RECOMMENDED MOUNTING HOLE PATTERN FOR 1.78 MAX THICK P.C. BOARD COMPONENT SIDE SHOWN

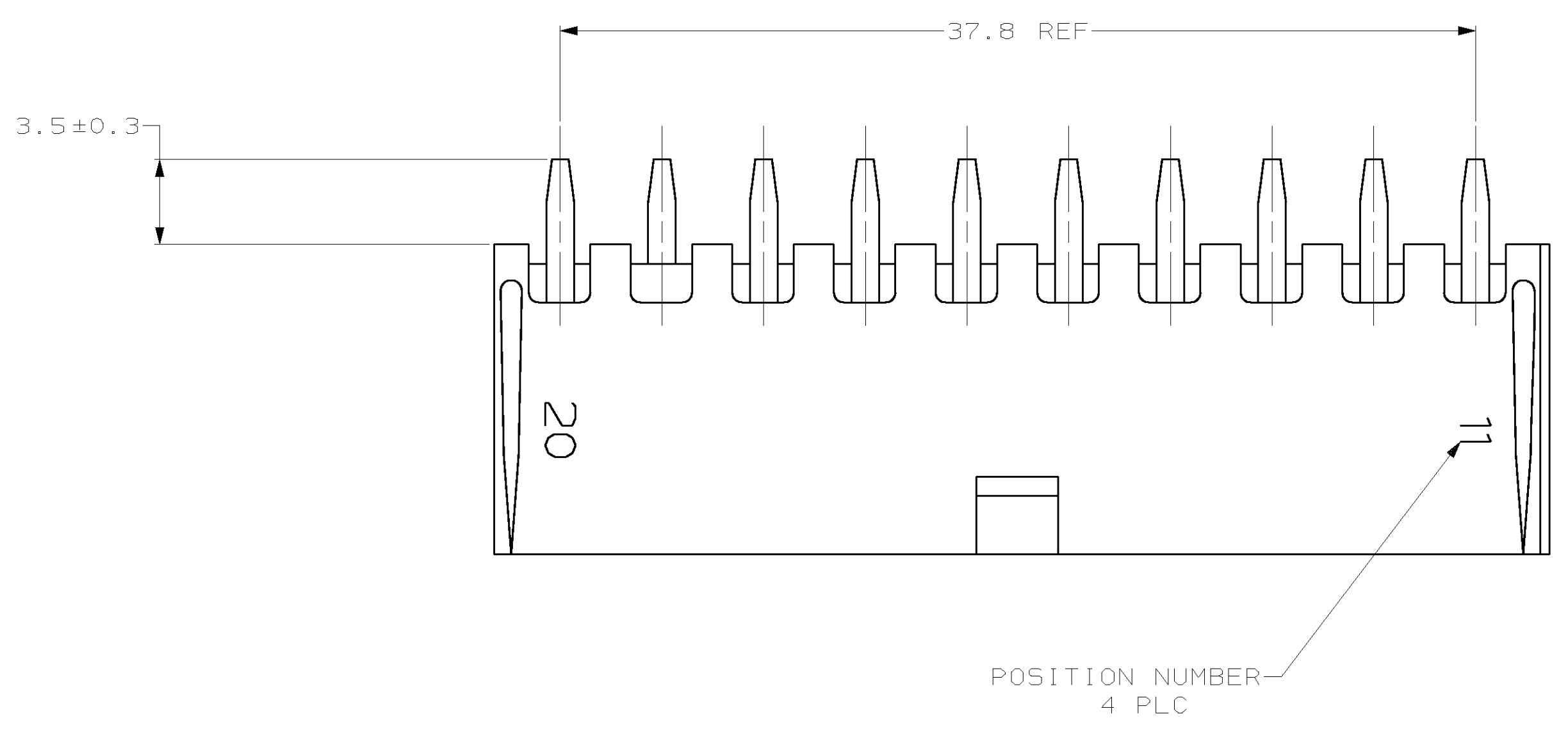
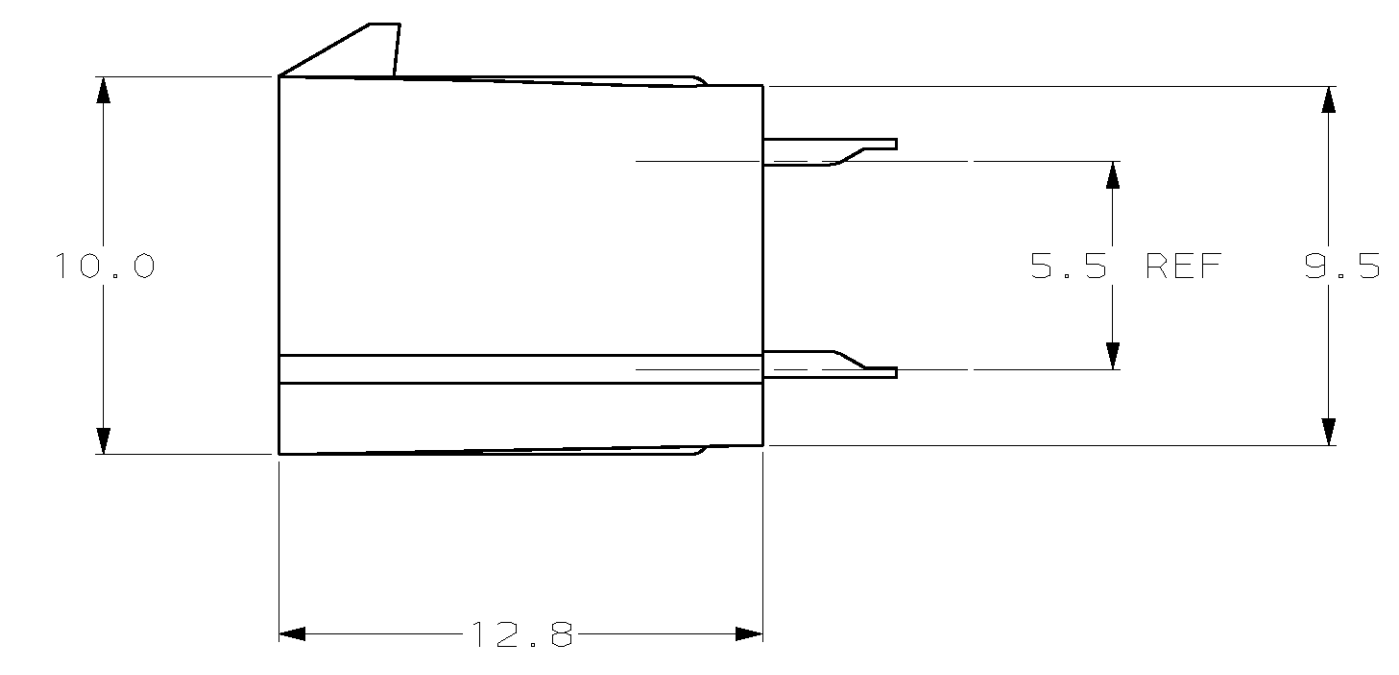
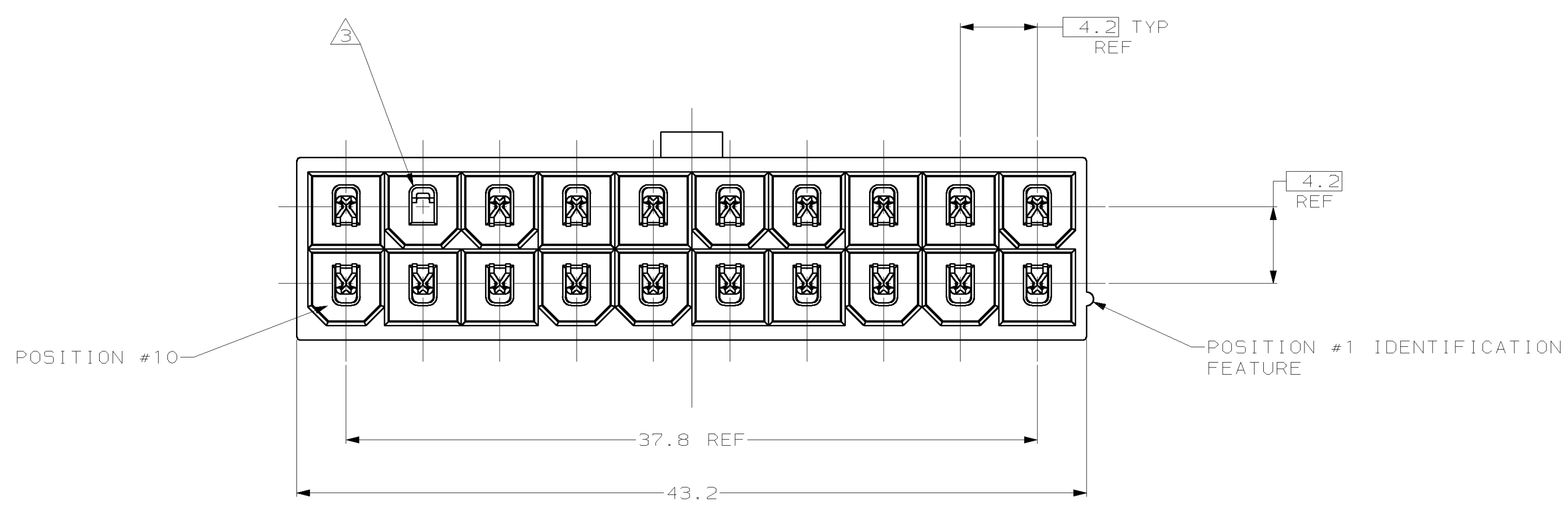

①	②	①	①	794430-1
MATERIAL	FINISH	MATERIAL	COLOR	PART NUMBER
CONTACT		HOUSING		
THIS DRAWING IS A CONTROLLED DOCUMENT.		DWN R. VESTAL 3-18-98	AMP Incorporated Harrisburg, PA 17105-3608	
TOLERANCES UNLESS OTHERWISE SPECIFIED.		CHK R. SWING 3-18-98	NAME ASSEMBLY, HEADER, HI-TEMP, VERTICAL, 20 POSITION, CIRCUIT 19 OMITTED, AMP-DUAC™ POWER CONNECTOR	
DIMENSIONS: mm	0 PLC ±- 1 PLC ±0.2 2 PLC ±0.13 3 PLC ±- 4 PLC ±-	APVD C. CASH 3-18-98	PRODUCT SPEC 108-1699	
MATERIAL SEE TABLE		FINISH 40° 30'	WEIGHT -	SIZE A1
SEE TABLE		SEE TABLE	CUSTOMER DRAWING	SCALE 5:1 SHEET 1 OF 1 REV C